

角スプライン

JIS B 1601 : 1996

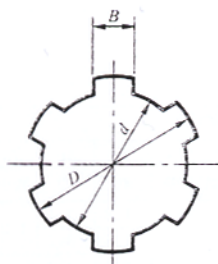

d mm	軽荷重用				中荷重用			
	呼び方 $N \times d \times D$	N 溝数	D mm	B mm	呼び方	N	D mm	B mm
11	—	—	—	—	6 × 11 × 14	6	14	3
13	—	—	—	—	6 × 13 × 16	6	16	3.5
16	—	—	—	—	6 × 16 × 20	6	20	4
18	—	—	—	—	6 × 18 × 22	6	22	5
21	—	—	—	—	6 × 21 × 25	6	25	5
23	6 × 23 × 26	6	26	6	6 × 23 × 28	6	28	6
26	6 × 26 × 30	6	30	6	6 × 26 × 32	6	32	6
28	6 × 28 × 32	6	32	7	6 × 28 × 34	6	34	7
32	8 × 32 × 36	8	36	6	8 × 32 × 38	8	38	6
36	8 × 36 × 40	8	40	7	8 × 36 × 42	8	42	7
42	8 × 42 × 46	8	46	8	8 × 42 × 48	8	48	8
46	8 × 46 × 50	8	50	9	8 × 46 × 54	8	54	9
52	8 × 52 × 58	8	58	10	8 × 52 × 60	8	60	10
56	8 × 56 × 62	8	62	10	8 × 56 × 65	8	65	10
62	8 × 62 × 68	8	68	12	8 × 62 × 72	8	72	12
72	10 × 72 × 78	10	78	12	10 × 72 × 82	10	82	12
82	10 × 82 × 88	10	88	12	10 × 82 × 92	10	92	12
92	10 × 92 × 98	10	98	14	10 × 92 × 102	10	102	14
102	10 × 102 × 108	10	108	16	10 × 102 × 112	10	112	16
112	10 × 112 × 120	10	120	18	10 × 112 × 125	10	125	18